

# J-VT02<sup>®</sup>

## FEATURES AND SPECIFICATIONS



### Construction

- Whole PC material body, excellent stress and UV resistance. Waterproof, dust-proof and anti-corrosion 4FT and 8FT Options

### Electrical

- Input Voltage: 120-277vac
- IP 65 waterproof grade
- Wattage and CCT tun-able
- High lumen efficient 125lm/w on average
- Motion sensor, emergency function for option

### Applications

- Offices, retail, supermarket, schools subway& train station, warehouse healthcare,residential,and hospitality applications

### Installation

- Hanging and ceiling installation

### Listing

- Comply with the requirements of the Standard(s) for Luminaires (CAN/CSA-C22.2No.250.0) and are identified with the cETL

### Warranty

- 5-year limited warranty



Specs at a Glance	* Nominal Wattage (Switchable)	
Configuration	TP4F-L50PDN	TP8F-S80PDN
CCT (K)	5CCT Selectable: 3500K-4000K-5000K-5700K-6500K	
Wattage (W)	25W/30W/35W/40W/50W	40W/50W/60W/70W/80W
Efficacy (LPW)	125lm/w	
Size	4FT	8FT
CRI	>80	
Input Voltage	120-277V AC	
Operating Temp	-20°C-45°C	
Certifications	ETL DLC 5.1 Premium	ETL
Warranty	5-year limited warranty	



## Ordering information

Brand	Size	Wattage xxxW	CCT"XX"	Blank"xx"	Input Voltage
Jee Lighting	4F 4FT 8F 8FT	50 25W-30W-35W - 40W-50W 80 40W-50W-60W - 70W-80W	3500-4000-5000 - 5700-6500K S CCT and Wattage Selectable	Blank Motion Sensor& Emergency Backup M Motion Sensor EM Emergency Backup N Non-montion&emergency	120-277Vac

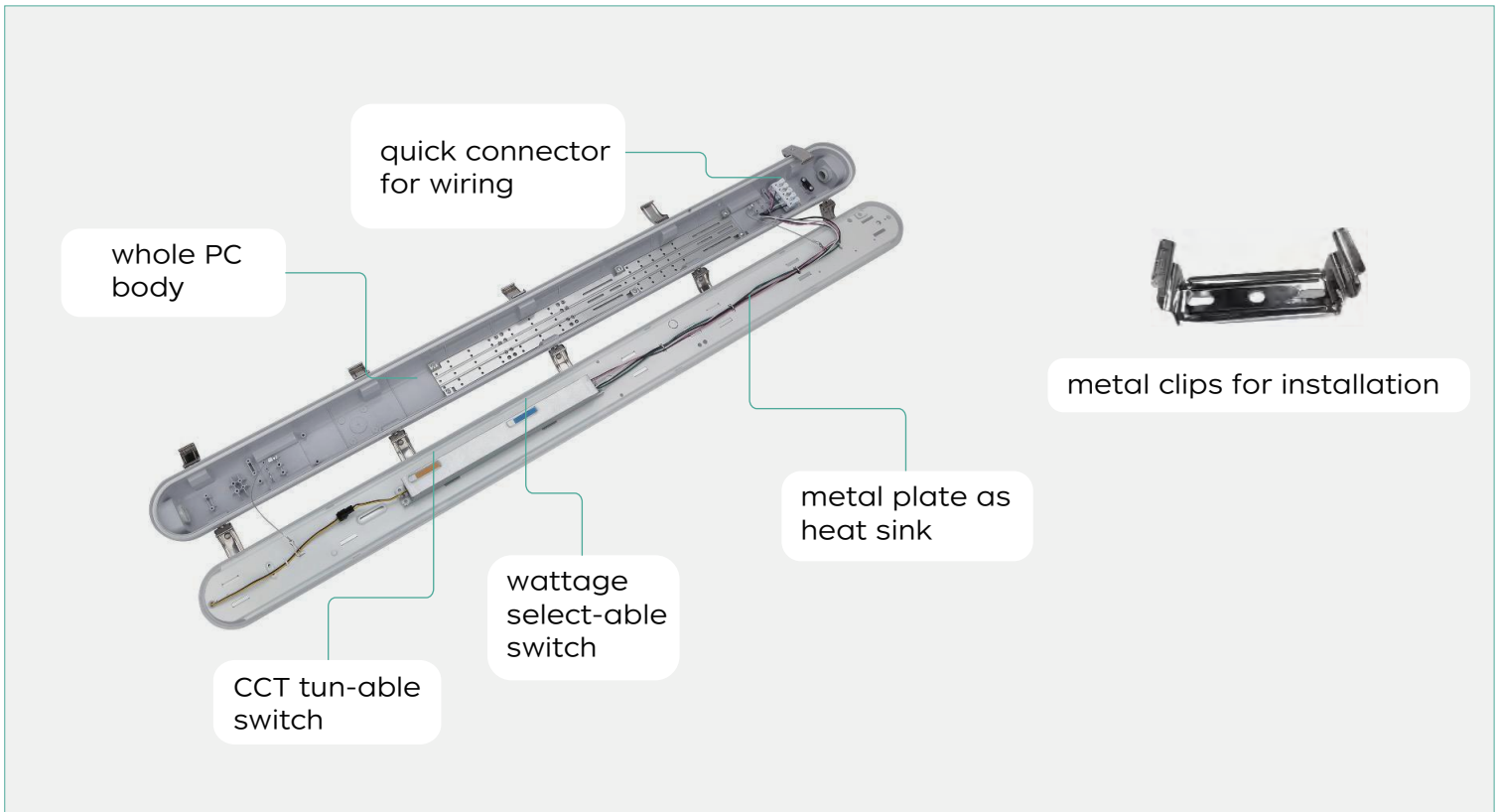



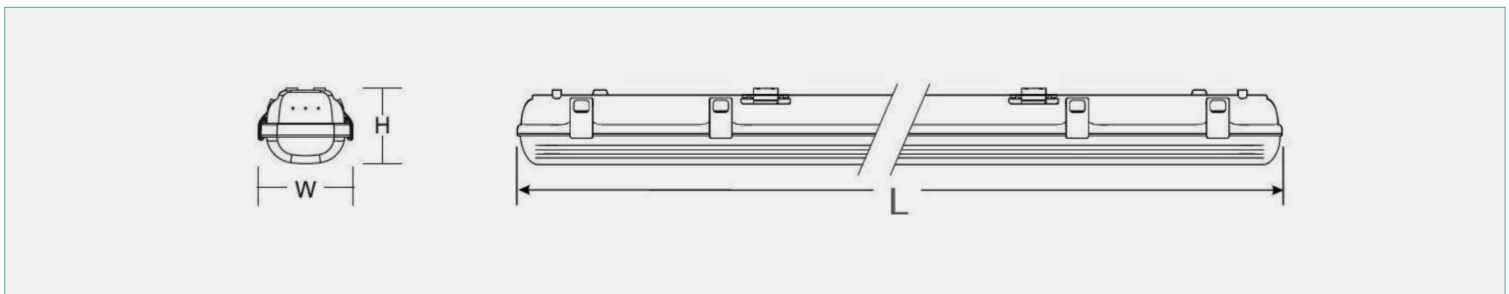

## Multiple Sensor Solutions



Length	Width	Height
1200mm/47"	95mm/3.74"	80mm/3.15"
2400mm/94"	95mm/3.74"	84mm/3.15"

## ACCESSORIES

	<p><b>Metal clips</b></p> <ul style="list-style-type: none"> <li>Stainless steel material</li> <li>2pcs for 4FT light, 4pcs for 8FT light</li> </ul>
	<p><b>Connection terminal</b></p> <ul style="list-style-type: none"> <li>waterproof IP65</li> <li>Lead the connection wires inside the lamp</li> </ul>
	<p><b>Metal hook</b></p> <ul style="list-style-type: none"> <li>Stainless steel material</li> <li>For hanging light</li> <li>2pcs for 4FT light, 4pcs for 8FT light</li> </ul>
	<p><b>Screws bag</b></p> <ul style="list-style-type: none"> <li>All the screws will be used for installation are packed in this bag</li> </ul>

## INSTALLATIONS

※Slide the switches on the driver to select the desired CCT and wattage before installation.

### Dimming Wiring Diagrams

This vapor tight light is compatible with 0-10V output dimming controls.

 <p>CCT tun-able switch</p> <p>wattage select-able switch</p>	 <p>Wiring diagram showing connections for LINE, NEUTRAL, GND, DIM+, and DIM- to the LED Vapor Tight Light. The connections are: LINE (BLACK), NEUTRAL (WHITE), GND (GREEN), DIM+ (PURPLE), and DIM- (GREY/PINK).</p>
--	---

## Surface Mounting

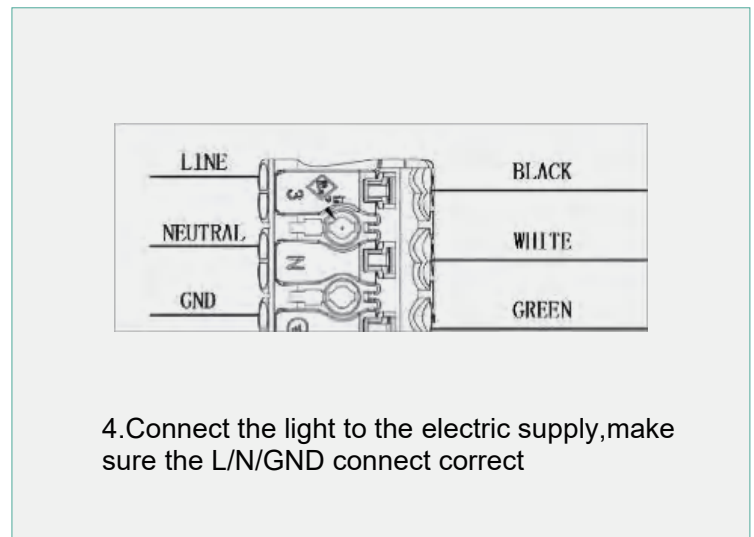
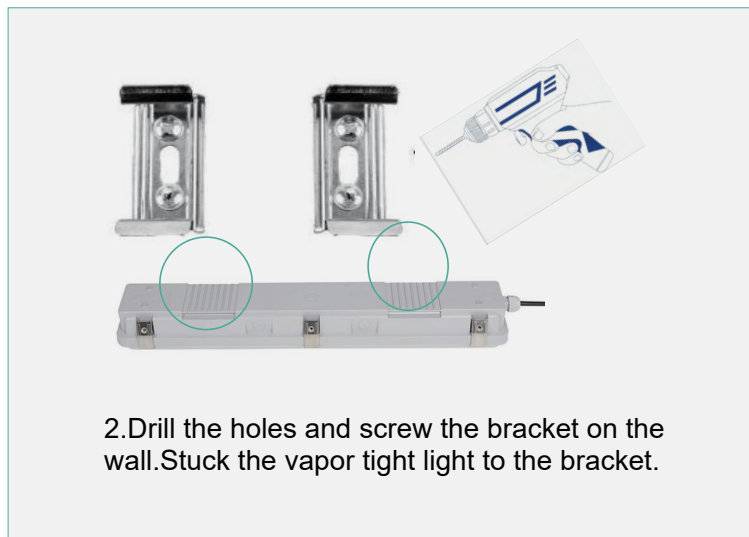
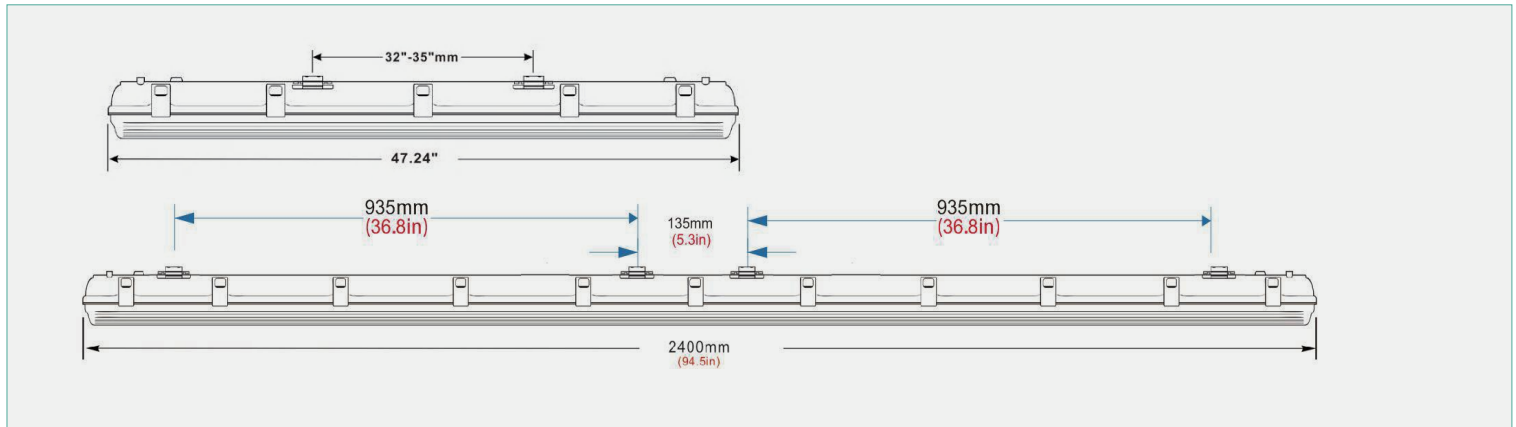

## Packing Info



SIZE	Carton size(inch)	N.W(LBS)	G.W(LBS)	QTY/CTN	20'GP(PCS)	40GP(PCS)
4FT	47.83"*12.6"*7.87"	11.2	14	6pcs	2166	4404
8FT	94.88"*12.64"*8.46"	23.4	28.59	6pcs	1014	2058